

EL-OP-B2 Remote Keypad User Manual

1. Keypad dimensions and Installation dimensions

NOTE: When use remote keypad, SG+/SG-(RS485) serial communication function disabled.

Keypad dimensions

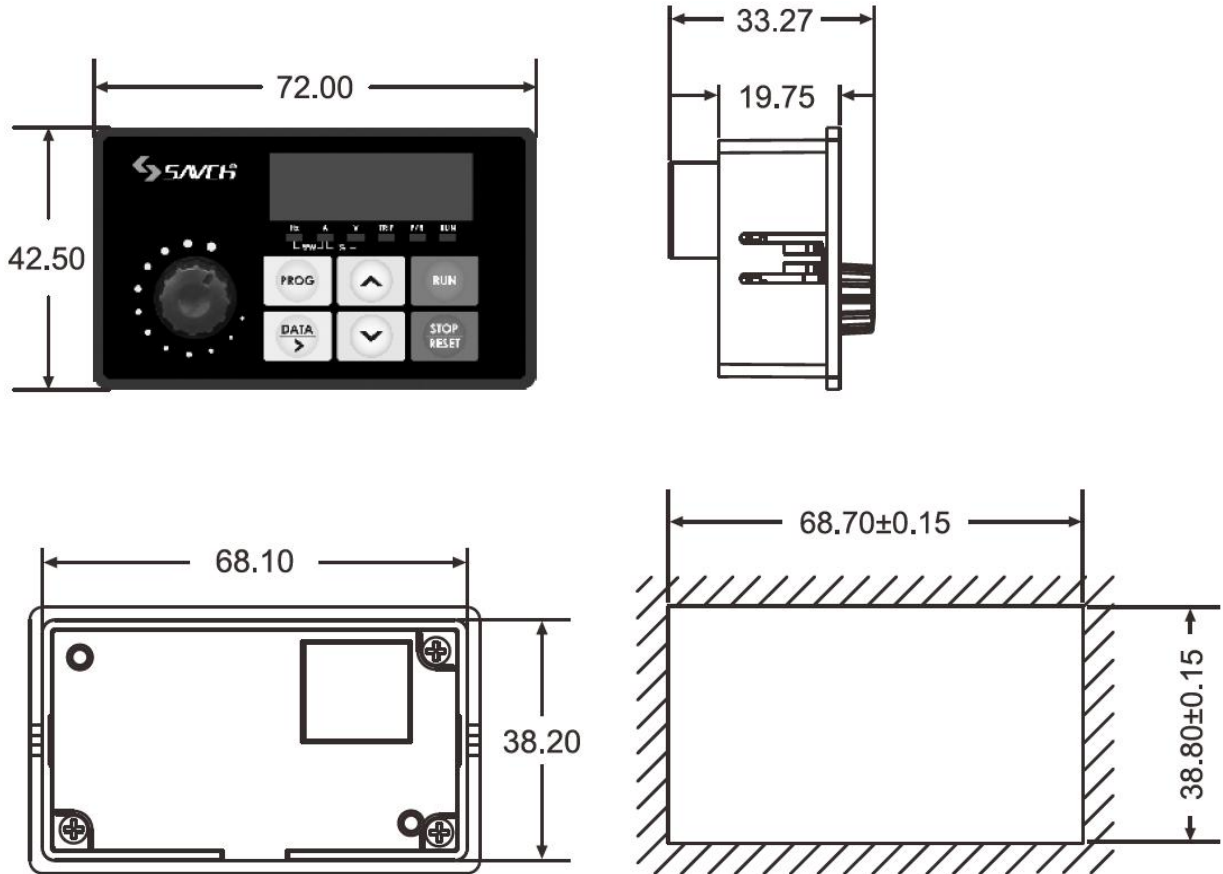

Keypad dimensions Installation

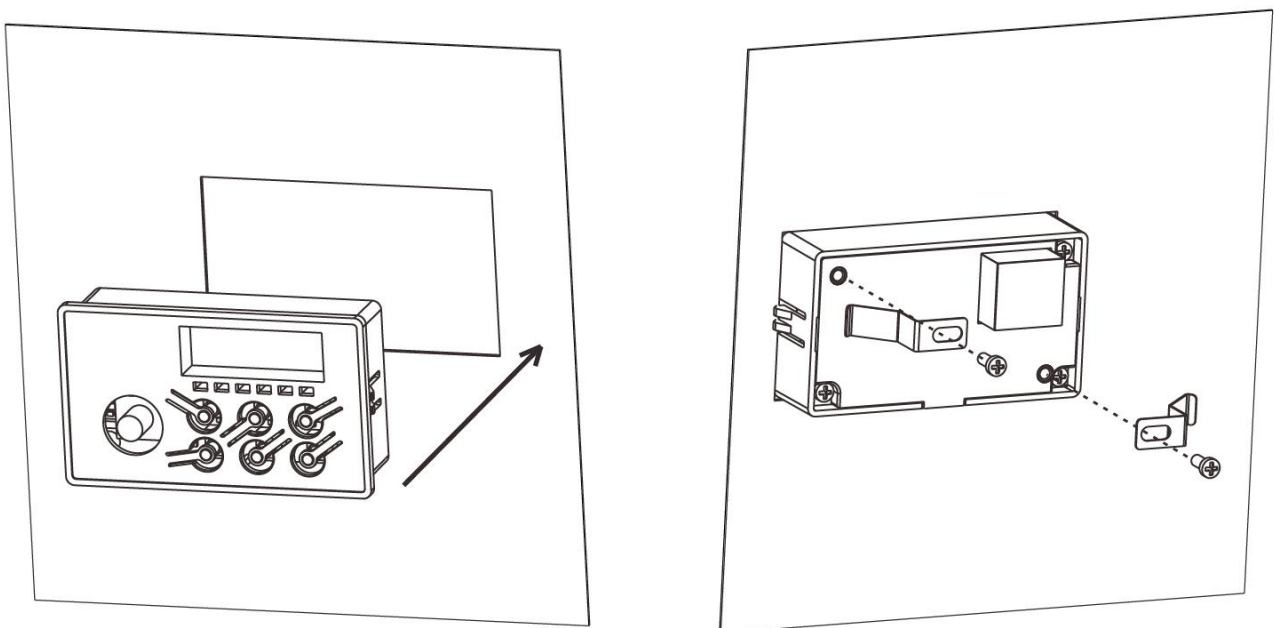

Remote keypad (EL-OP-B2) external dimensions and installation dimensions.

(This keypad can be extended with ordinary network cable (8 cores))

2. Parameter function description

Parameter	Parameter function	Setting range	Setup parameter
00-02	Main frequency source selection	0~5 6:Communication setting(Remote keypad) 7~9	6
00-11	Parameter initialization	0~2 3:Copy inverter parameters to keypad 4:Copy keypad parameters to Inverter	3 or 4

3. Remote keypad failure code description

Failure code	Description	Possible reason	Corrective-measures
CErr	Communication error	Communication happen twice interrupted	1.Check if broken line occurs,or whether the peripheral equipment has a strong interference source 2.Return to the factory
EErr	I2C communication error	I2C communication error with MCU	Return to the factory
uErr	Inverter type no match	Inverter type no match	Use the correct inverter type
dErr	Date invalid	Date invalid	Copy inverter parameters to keypad first
nErr	Operation error	Operation error	Return to the factory